

**特点Characteristic**

- 1、最高20A触点切换能力  
Up to 20A contact switching capability
- 2、具有一组常开、一组转换触点形式  
1 Form A and 1 Form C configurations
- 3、具有多种插座可供选择  
Sockets available
- 4、外形尺寸 (19.0×15.4×15.5) mm  
Overall dimensions (19.0×15.4×15.5) mm



**触点参数Contact parameters**

型号Model	WL73		
触点形式Contact form	1C(SPDT(B-M))	1A(SPSTNO)	1B(SPSTNC)
最大切换电流Maximum switching current	10A	16A	10A
最大切换电压Maximum switching voltage	277VAC/30VDC	277VAC/30VDC	277VAC/30VDC
最大切换功率Maximum switching power	2770VA/300W	4432VA/480W	2770VA/300W
触点负载 (阻性) Contact load (resistive)	10A 277VAC 10A 30VDC	16A 277VAC 16A 30VDC	7A 277VAC 7A 30VDC

**性能参数Performance parameter**

触点材料Contact material	银合金 Ag alloy	
接触电阻Contact resistance	Max 100MΩ	
动作时间Action time	≤10ms	
释放时间Release time	≤5ms	
绝缘电阻Insulation resistance	Min 100MΩ (500VDC)	
介质耐压 Dielectric Strength	触点间 Between contacts	AC 750VAC 50/60Hz 1min
	触点线圈间 Between contact coils	AC 1500VAC 50/60Hz 1min
冲击 To attack	稳定性Stability	98m/s <sup>2</sup>
	强度Strength	980m/s <sup>2</sup>
振动Vibration	10~55Hz 双振幅Double Amplitude 1.5mm	
机械寿命Mechanical endurance min	1×10 <sup>7</sup>	
电气寿命Electrial eddurance min	1×10 <sup>5</sup>	
相对湿度Humidity	5%~85%RH	
环境温度Ambient temperature	-40°C~105°C	
重量Weight	约Approx 9g	

**订货示例Ordering example**

	WL73	-S	-1	12	D	M	X
继电器型号 Type							
密封型式: F-防尘式, S-塑封式 Construction: F-Flux proofed ,S-Plastic Sealed							
继电器触点组数: 1-1组触点 Number of Poles: 1-1 group							
线圈电压: 3, 5, 6, 9, 12, 24, 48VDC Coil Voltage: 3, 5, 6, 9, 12, 24, 48VDC							
线圈功率: D-0.36W, 无-0.45W, H-0.8W Coil Power: D-0.36W, Nil-0.45W, H-0.8W							
触点形式: M-常开, 无-转换, B-常闭 Contact Arrangement: M-N/O , Nil-C/O , B-N/C							
特规参数: 根据客户要求定制, 无-标准型 Special parameters: customized according to customer requirements, Nil-standard							

**线圈参数Coil parameters**

(at 20°C)

型号规格 Coil Voltage		线圈电阻 Coil Resistance	动作电压 Pick-up Voltage 额定电压的75% 75% of rated voltage	释放电压 Drop-out Voltage 额定电压的10% 10% of rated voltage	功率 Coil Power
额定 rated	最大 Max				
VDC		$\Omega \pm 10\%$	VDC	VDC	W
3	3.9	25	2.25	0.3	0.36
5	6.5	69	3.75	0.5	
6	7.8	100	4.5	0.6	
9	11.7	225	6.75	0.9	
12	15.6	400	9	1.2	
24	31.2	1600	18	2.4	
5	6.5	56	3.75	0.5	0.45
9	11.7	180	6.75	0.9	
12	15.6	320	9	1.2	
24	31.2	1280	18	2.4	
12	15.6	180	8	1.2	0.8
24	31.2	720	16	2.4	

安全认证负载 Safety certified load

认证类别 Certification category	CQC	TUV	UL
认证负载 Certified load	16A/12A,277VAC/250VAC 16A/12A,30VDC 20A/15A,125VAC 10A/7A, 277VAC/250VAC 10A/7A,30VDC	16A/12A,277VAC/250VAC 16A/12A,30VDC 20A/15A,125VAC 10A/7A, 277VAC/250VAC 10A/7A,30VDC	16A/12A/10A, 277/250/125 VAC 16A/12A/10A 30VDC 20A, 125 VAC TV-8, 125/250VAC 5A, 120VAC 1000W, 120VAC 5A, 277VAC 1/2hp, 125VAC 1/4hp, 250VAC 10A/5A 277/250AC/30VDC

外形及安装图 Outline and installation drawing

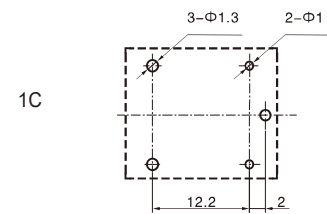
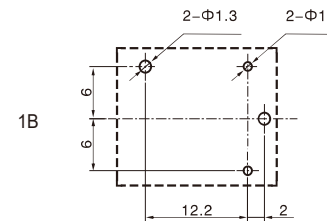
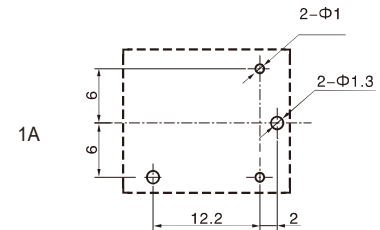
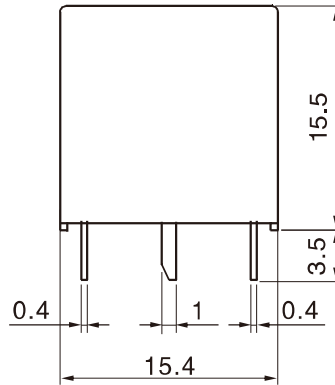
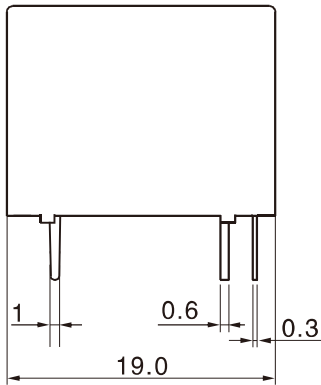

Undimensioned tolerance: <1mm: ±0.2mm 1~5mm: ±0.3mm >5mm: ±0.4mm  
未标注尺寸公差: <1mm: ±0.2mm 1~5mm: ±0.3mm >5mm: ±0.4mm

Note: 1. The size of the lead foot is pre welding dimension. 注: 1、引出脚尺寸为预焊前尺寸  
2. installation hole size tolerance: +0.1mm 2、安装孔尺寸公差: ±0.1mm

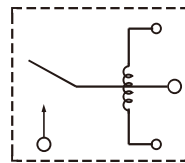
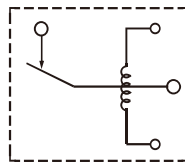
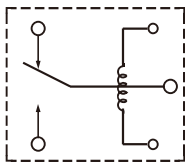

Wiring diagram (bottom view)  
接线图 (底视图)

Mounting hole size (bottom view)  
安装孔尺寸 (底视图)

性能曲线图 Performance chart

